

# Champion®



## HEATING TORCH SETS

Models; PC108, PC109, PCSF109, PC216, PKP411,  
PS555, PS560 & PLK1074

Part Nos: 3404115, 3404100, 3404105, 3404110, 3404125, 3404000,  
3404005 & 3404135

## OPERATING & SAFETY INSTRUCTIONS

CE

GC01/15

---

## INTRODUCTION

---

Thank you for purchasing this CLARKE Heating Torch Set, designed for trade use. They are all to be used only with propane gas and are supplied with a standard 3/8" BSP (LH) hose.

Before attempting to use the product, it is essential that you read this manual thoroughly and carefully follow all instructions given. In doing so you will ensure the safety of yourself and that of others around you, and you can also look forward to the product giving you long and satisfactory service.

---

## GUARANTEE

---

This CLARKE product is guaranteed against faulty manufacture for a period of 12 months from the date of purchase. Please keep your receipt as proof of purchase.

This guarantee is invalid if the product is found to have been abused or tampered with in any way, or not used for its intended purpose.

Faulty goods should be returned to their place of purchase, no product can be returned to us without prior permission.

This guarantee does not effect your statutory rights.

---

## SAFETY PRECAUTIONS

---

1. ALWAYS follow all precautions regarding the use of Propane gas cylinders. (see manufacturers/suppliers instructions)
2. Ensure the gas hose is in perfect condition before use. If in doubt, have it replaced.
3. Ensure all connections are fully secure before use.
4. Never transport the gas bottle by holding the regulator or gas hose.
5. NEVER point the torch at any person or animal.
6. Take great care when placing the torch down. Do not allow it to come into contact with flammable surfaces, or any surface which could be damaged by heat. Use the stand supplied with the PLK1074 to support the nozzles clear of any supporting surface.
7. Never use the torch in an explosive atmosphere, or where there is danger of fire.
8. IMPORTANT! If used indoors, ensure there is adequate ventilation.

Please keep these instructions in a safe place for future reference.

---

## ASSEMBLY

---

**NOTE: A bottle of propane gas is required for use with this equipment, capable of delivering a pressure of 4 bar. (A regulator is provided)**

1. Turn the knob on the regulator fully clockwise, then attach the regulator to the gas bottle, ensuring it is tight.
2. Attach the hose supplied, to the regulator at one end, and the torch at the other, noting that the hose connections have LEFT HAND THREADS, i.e. turn them anticlockwise.
3. Attach the appropriate nozzle/burner to the torch where necessary.

If a nozzle/burner is already attached, remove it carefully, complete with adapter (see illustration below). Unscrew the nozzle from the adapter and replace with that of the desired type or size. Screw the adapter with nozzle back on to the torch.

### Note:

1. **Model PKP411 requires the torch extension to be attached to the torch.**

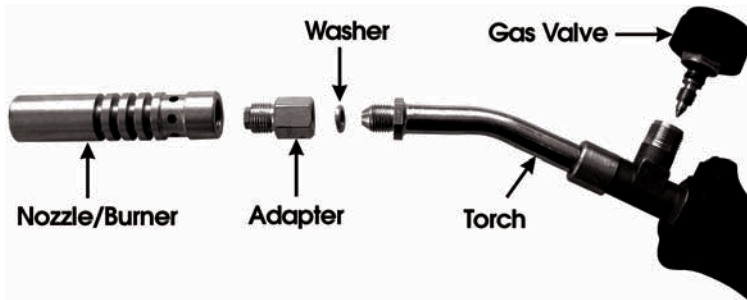

---

## OPERATION

---

With the hose and regulator attached, and ensuring the gas tap on the torch is closed, i.e. turned fully clockwise, open the gas regulator valve.

Gas will now be available at the torch, the volume of which will depend upon the regulator valve opening.

Very gently, open the gas valve on the torch, ensuring the nozzle/burner is pointing well away from people or property, and apply a flame to the end of the burner. Model PKP411 is equipped with a piezo electric starter on the torch extension. Press the button until ignition occurs. Adjust the gas valve until the desired flame is achieved.

Some models have a control lever attached to the torch. This is used to further regulate the gas flow and hence the intensity of the flame. When the lever is released the flame will reduce to a pilot light.

In the case of the PC109 kit, the flame can also be adjusted by positioning the clip-on sleeve provided, over the air holes in the circumference of the 17mm screw-tipped nozzle.

Models PC216, PKP411 and PLK1074 have a support arm which can be clamped to the nozzle extension to steady the unit at rest. This should be fitted to ensure the flame points upwards, away from any supporting surface.

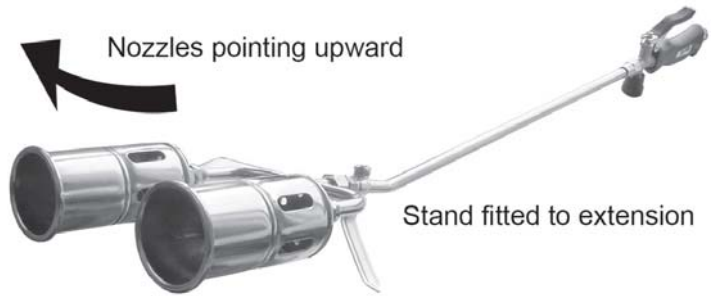

---

## MAINTENANCE

---

The torches are maintenance free, except for visual checks before use to ensure all connections are secure, and the gas hose is in perfect condition. If the nozzle becomes sooted, clean with a soft wire brush. DO NOT poke wire etc, through the holes in the nozzle.

To remove the filter from the nozzle for cleaning, grasp the nozzle with a pair of mole grips or very carefully secure in a vice, then unscrew the filter.

The parts on the following pages are all available from your CLARKE dealer.

---

## COMPONENT PARTS

---

### PLK 1074

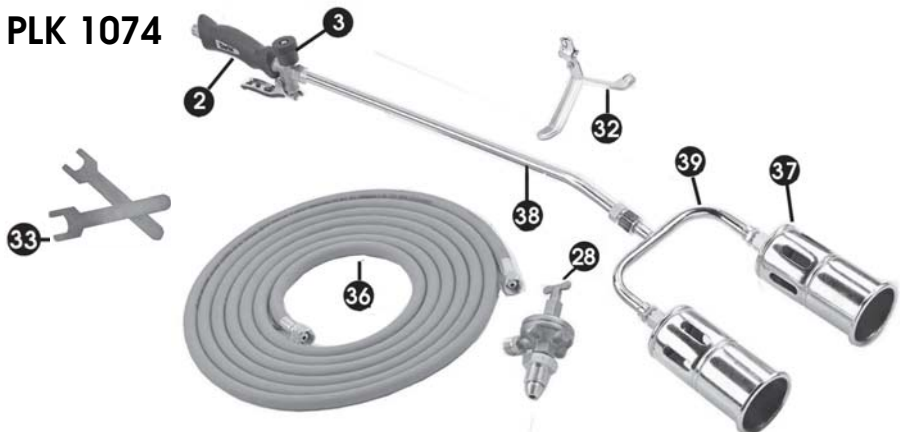

# PC 108

Sleeve may be used to adjust air mix by covering holes as necessary to produce desired flame when used with nozzle(35) only.



34

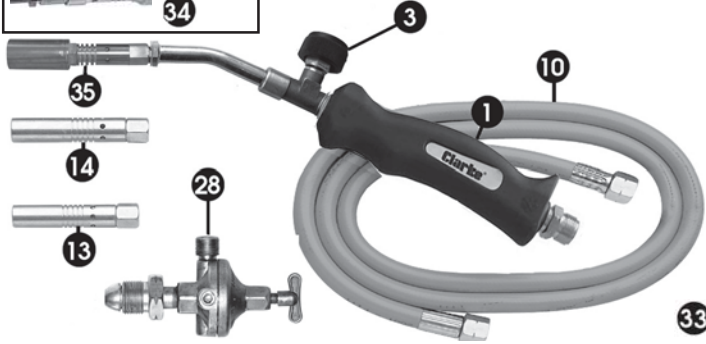
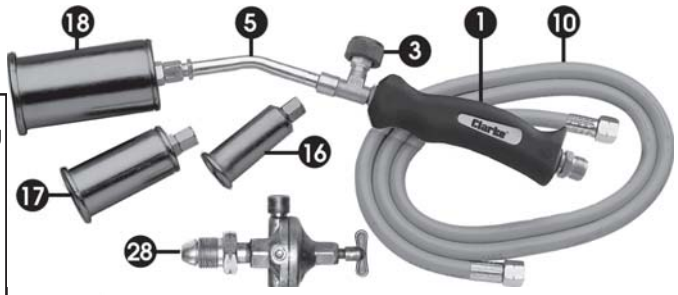

# PC 109



# PCSF 109

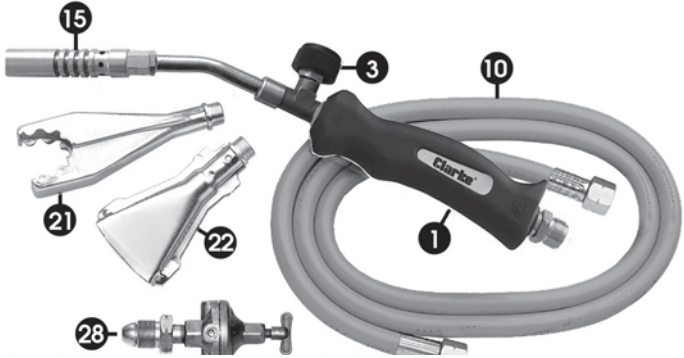

# PC 216



# PKP 411

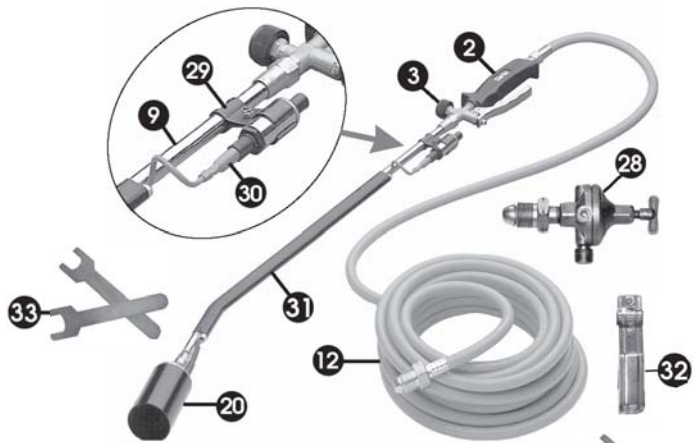

# PS 555



# PS 560

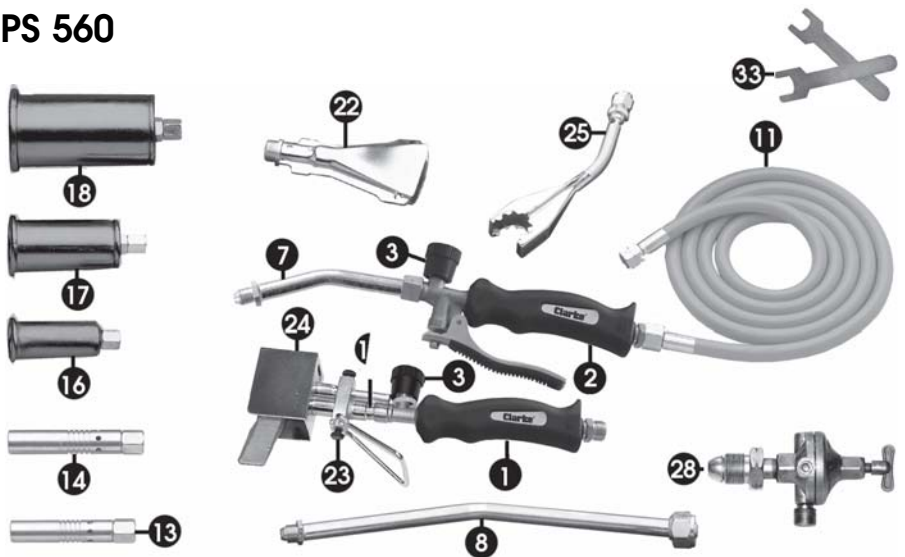

## SPARE PARTS LIST

Ref	Description	Part No
1	Handle Assembly	IDFC10901
2	Handle/Trigger Assy	IDFK41102
3	Control Knob Assy	IDFC10903
4	Extension 80 mm	IDFC10904
5	Extension 110 mm	IDFC10805
6	Extension 350 mm	IDFC21606
7	Extension 10 mm (kit)	IDFS56007
8	Extension 260 mm (kit)	IDFS56008
9	Extension 600 mm (P)	IDFKP41109
10	Hose 1500 mm	IDFC10910
11	Hose 2000 mm	IDFS55511
12	Hose 10,000 mm	IDFC21612
13	Nozzle 9 mm	IDFC10913
14	Nozzle 12 mm	IDFC10914
15	Nozzle 15 mm	IDFC10915
16	Nozzle 25 mm	IDFC10816
17	Nozzle 34 mm	IDFC10817
18	Nozzle 48 mm	IDFC10818
19	Nozzle 58 mm	IDFC21619
20	Nozzle Turbo 60 mm	IDFKP41120

Ref	Description	Part No
21	Pipe Burner	IDFCSF10921
22	Flat Burner	IDFCSF10922
23	Soldering Iron Adaptor	IDFK10123
24	Soldering Iron	IDFK10124
25	Pipe Burner with extrn	IDFS55525
26	Nozzle 14mm with extrn	IDFS55526
27	Nozzle 22mm with extrn	IDFS55527
28	Gas Regulator (new style*)	IDFS55528 *
29	Clamp	IDFKP41129
30	Piezo Igniter (inc cable)	IDFKP41130
31	Extension Cover	IDFKP41131
32	Support Stand	IDFK41132
33	Open Wrench	IDFK41133
34	Metal sleeve to fit 17 mm screw-tip nozzle item 35	IDFC10934
35	17mm Screw Tip Nozzle	IDFC10935
36	Hose 5000 mm	IDFPLK107436
37	Twin 60mm Burner	IDFPLK107437
38	Extension 500mm	IDFPLK107438
39	Fork Section	IDFPLK107439

## ENVIRONMENTAL PROTECTION



Do not dispose of this product or its packaging with general household waste. All tools, accessories and packaging contain valuable raw materials and should be sorted, taken to a recycling centre and disposed of appropriately.

# A SELECTION FROM THE VAST RANGE OF

# Clarke®

## QUALITY PRODUCTS

### AIR COMPRESSORS

From DIY to industrial, Plus air tools, spray guns and accessories.

### GENERATORS

Prime duty or emergency standby for business, home and leisure.

### POWER WASHERS

Hot and cold, electric and engine driven - we have what you need

### WELDERS

Mig, Arc, Tig and Spot. From DIY to auto/industrial.

### METALWORKING

Drills, grinders and saws for DIY and professional use.

### WOODWORKING

Saws, sanders, lathes, mortisers and dust extraction.

### HYDRAULICS

Cranes, body repair kits, transmission jacks for all types of workshop use.

### WATER PUMPS

Submersible, electric and engine driven for DIY, agriculture and industry.

### POWER TOOLS

Angle grinders, cordless drill sets, saws and sanders.

### STARTERS/CHARGERS

All sizes for car and commercial use.

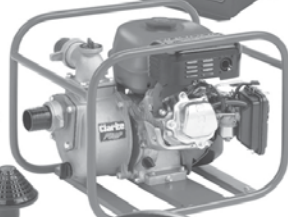

**PARTS & SERVICE: 0208 988 7400**

**E-mail: [Parts@clarkeinternational.com](mailto:Parts@clarkeinternational.com) or [Service@clarkeinternational.com](mailto:Service@clarkeinternational.com)**

**SALES: UK 01992 565333 or Export 00 44 (0)1992 565335**

**Clarke** INTERNATIONAL Hemnall Street, Epping, Essex CM16 4LG  
[www.clarkeinternational.com](http://www.clarkeinternational.com)